

V-Counter[®]

New generation of hematology analyzers

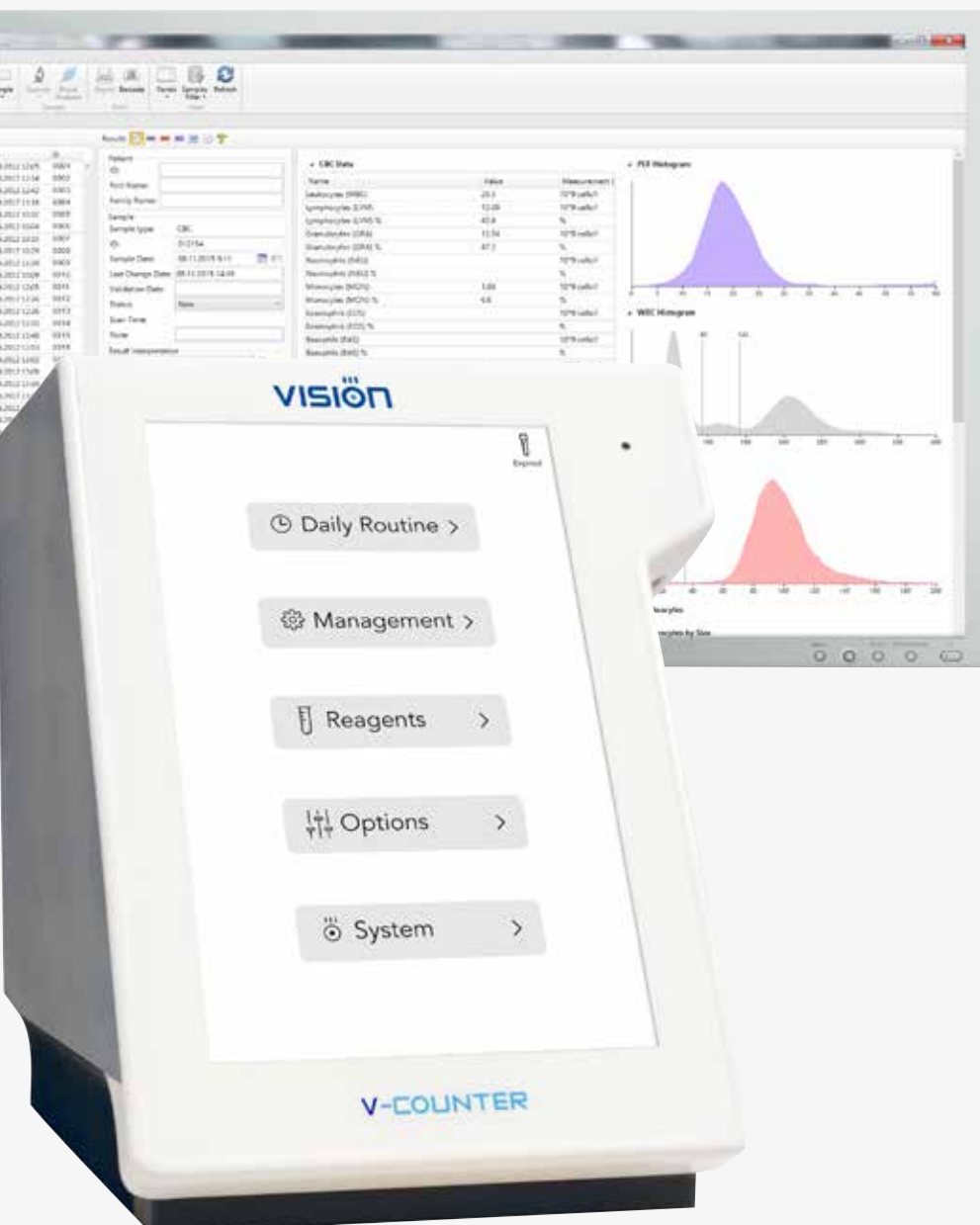

The best for small-
and medium sized
laboratories

Ideal for pediatric use

Special mode for POC

Smallest reagent
consumption

Capillary measurement

Efficient and economical analyzer

80%

Reagent consumption is less by approx. 80% due to microfluidics technology.



CBC measurement can be done by a $<10 \mu\text{L}$ sample. This is very useful for infant examination where venous blood is difficult to collect.

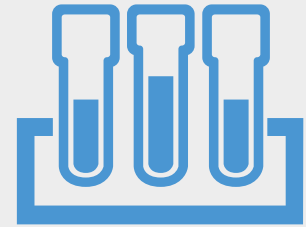

V-Counter[®] operates with any type of open and closed EDTA test-tubes available in the market.

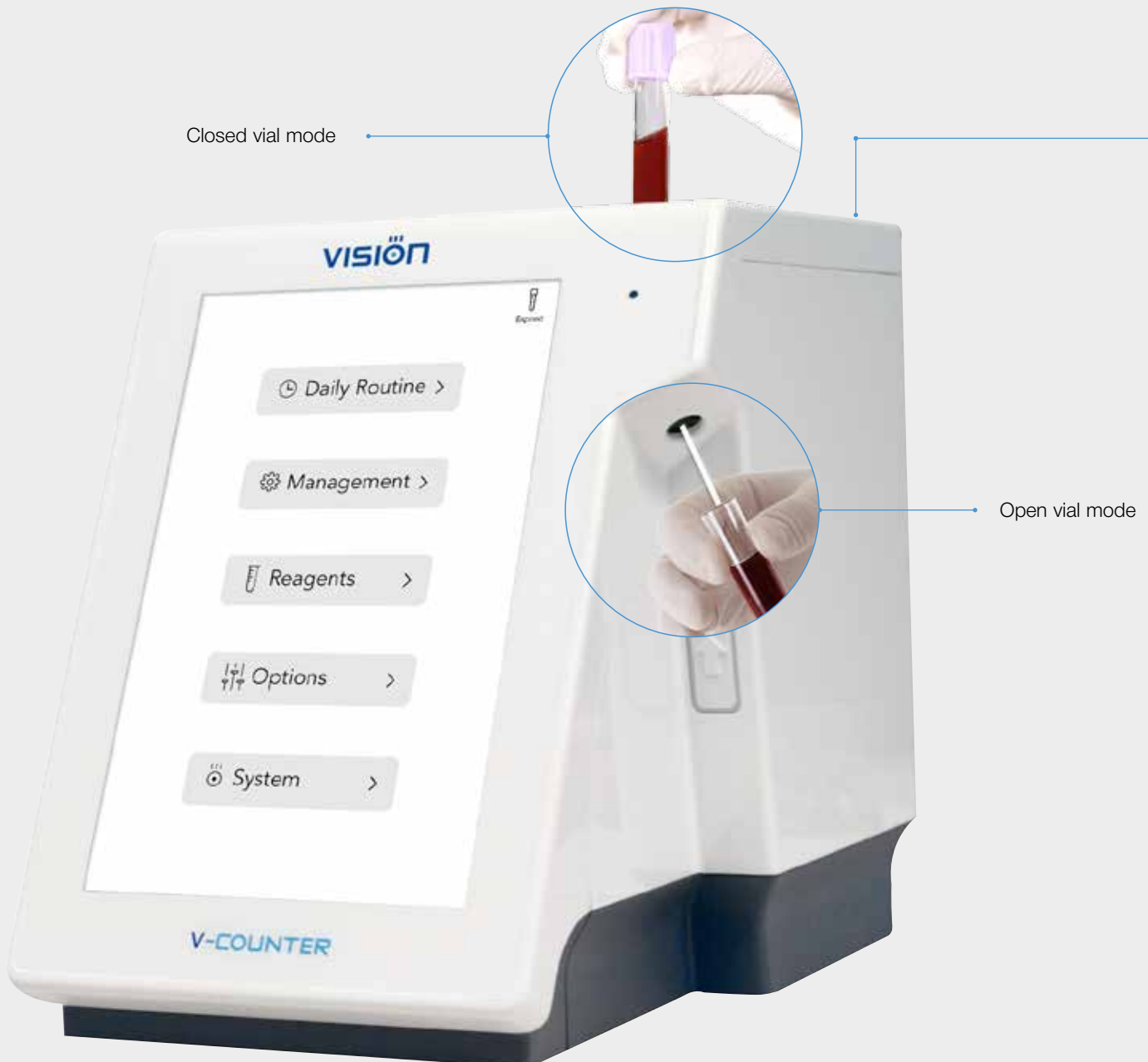

Closed vial mode

Open vial mode

Automated analysis for 26 parameters, including a 3-part differential

Leucocytes (WBC)	Mean corpuscular hemoglobin (MCH)
Lymphocytes (LYM%)	Mean corpuscular hemoglobin concentration (MCHC)
Lymphocytes, % (LYM%)	Platelets (PLT)
Mid-sized cells (MID)	Mean platelet volume (MPV)
Mid-sized cells, % (MID%)	Plateletcrit (PCT)
Granulocytes (GRA)	Platelet distribution width (PDWs)
Granulocytes, % (GRA%)	Platelet distribution width, % (PDWc)
Hemoglobin (HGB)	Platelet large cell ratio (P-LCR)
Erythrocytes (RBC)	Platelet large cell concentration (P-LCC)
Hematocrit (HCT)	Large platelet concentration ratio (LPCR)*
Mean corpuscular volume (MCV)	Large platelet concentration ratio, % (LPCR%)*
Red cell distribution width (RDWs)	Lymphocyte index (LYMi)*
Red cell distribution width, % (RDWc)	Neutrophil-to-lymphocyte ratio (NLR)*

* available for V-Counter® PC Analyzer only



1 V-Counter® PC Analyzer

Automated hematology PC-analyzer for 26 parameters, including a 3-part differential

The results are automatically transferred to your PC.

You may print report, save it on PC or send it by e-mail.



2 V-Counter® Integro

Integrated solution for a complete blood count.

Combines analysis results from hematology analyzer and blood cell morphology from Vision Hema® imaging analyzer.

Specification

Parameters	WBC, LYM, MID, GRA, LYM%, MID%, GRA%, HGB, RBC, HCT, MCV, RDWs, RDWc, MCH, MCHC, PLT, MPV, PCT, PDWs, PDWc, P-LCR, P-LCC, LPCR*, LPCR%*, LYMi*, NLR*
Histograms	WBC, RBC, PLT
Measurement technology	volumetric impedance measurement combined with microfluidic technology
Sample volume	<10 µl whole blood (with EDTA) (open tube sampling mode)
Throughput	— open vial mode — 45 tests / hour — closed vial mode — 60 tests / hour
User interface	LCD, 10", 1280x800 with capacitive touchscreen
Dimensions (HxWxD)	263x206x313 mm
Weight	<10 kg
Power	12 V, 5 A
Power consumption	maximum 45 W
Reagents consumption / test	— open vial mode — isotonic diluents: 5.5 ml; lyse: 1.0 ml; system solution: 2.0 ml — closed vial mode — isotonic diluents: 5.5 ml; lyse: 1.0 ml; system solution: 0.8 ml
Vision CBC® software	— automatic transfer of results from the hematology analyzer and entry into report — database management — automatic management of data statistics — blood analysis reports. Customizable guide to generate reports according to your personal requirements — remote access and data exchange with LIS/HIS
Available reagents	isotonic diluents solution, lysing solution, system solution, cleaning solution
Available hematology blood control	low level, normal level, high level (1 vials of 2.5 ml)

* available for V-Counter® PC Analyzer only

Ordering information

V-Counter®

Set includes: V-Counter® hematology analyzer, printer (option)

V-Counter® PC Analyzer

Set includes: V-Counter® hematology analyzer, Vision CBC® software, optional PC and printer

V-Counter® Integro

Set includes: V-Counter® hematology analyzer, Vision Hema® imaging analyzer, printer (option)

* Product images are shown for reference only and final product may differ

